

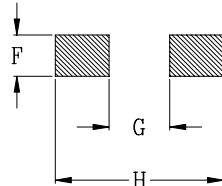

## DELTA P/N : HCB1260 Series

### Mechanical dimensions

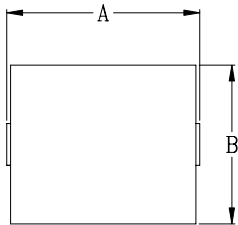

PCB LAYOUT

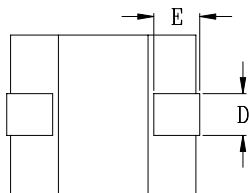

Dimensions (Unit : mm)

A	12.0 MAX
B	8.0 MAX
C	6.0 MAX
D	2.5
E	2.5
F	3.0
G	6.3
H	12.3

### Electrical Characteristics

Delta P/N	$L^1$ (nH)	Li (nH)MIN	DCR (m $\Omega$ )	$I_{sat}^2$ (A)	$I_r^3$ (A)
HCB1260-151	150	108	0.42 $\pm$ 7%	70	38
HCB1260-211	210	168		53	

1. Tolerance of inductance :  $\pm$  20%
2.  $I_{sat}$  is the DC current which cause the inductance drop not lower than Li
3.  $I_r$  is the DC current which cause the surface temperature of the part increase approximately 40 .
4. Operating temperature: -40 to 125 (Self-temperature rise included).